

# HSF

**NOTES:**

Rated Voltage:250V AC/DC  
 Rated Current:2.0AMP  
 Contact Resistance:20mΩ Max  
 Withstand Voltage:800V AC/minute  
 Insulation Resistance:1000MΩ Min  
 Operation Temperature:-25°C to +85°C  
 Contact Material:Brass  
 Contact plating:Au or Sn over Ni  
 Insulator Material:PA46 Or PA66(UL94V-0)

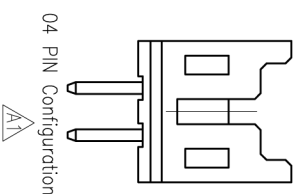
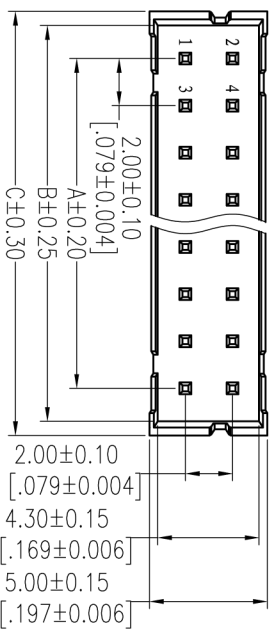

04 PIN Configuration

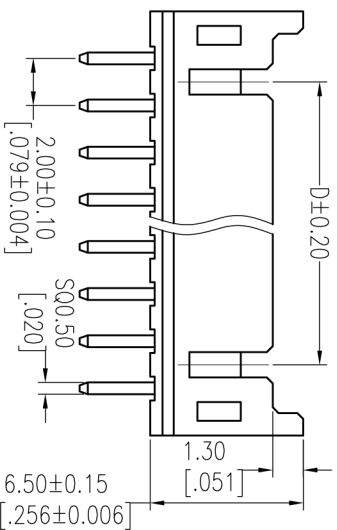

06-50 Pin Configuration

## Ordering Information

WF2002 - WS XX X 0 X

**Contact Plating**  
 H=P446 No. of pins  
 S0=Gold Flash/Tin S3=10u"Gold/Tin  
 Blank=P466 04-50P S4=15u"Gold/Tin  
 S5=30u"Gold/Tin  
 G0=Gold Flash  
 G3=10u"Gold  
 G4=15u"Gold  
 G5=30u"Gold  
 Blank=1Tin

**Color**  
 B=Black  
 E=Beige  
 W=White

**Packing**  
 O=PE Bag  
 T=Tube

Recommended P.C.B Layout(Top Side)  
 (PCB BOARD TOLERANCE±0.05)

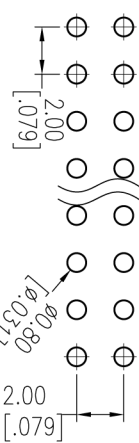

Specification & Ordering Information:

Circuit	Part No.	Dimension				Q'ty /Bag
		A	B	C	D	
04	WF2002-WS04X01	2.00	4.80	6.00	---	4,000
06	WF2002-WS06X0X	4.00	6.80	8.00	---	3,000
08	WF2002-WS08X0X	6.00	8.80	10.00	4.00	2,000
10	WF2002-WS10X0X	8.00	10.80	12.00	6.00	2,000
12	WF2002-WS12X0X	10.00	12.80	14.00	8.00	2,000
14	WF2002-WS14X0X	12.00	14.80	16.00	10.00	1,000
16	WF2002-WS16X0X	14.00	16.80	18.00	12.00	1,000
18	WF2002-WS18X0X	16.00	18.80	20.00	14.00	1,000
20	WF2002-WS20X0X	18.00	20.80	22.00	16.00	1,000
22	WF2002-WS22X0X	20.00	22.80	24.00	18.00	1,000
24	WF2002-WS24X0X	22.00	24.80	26.00	20.00	800
26	WF2002-WS26X0X	24.00	26.80	28.00	22.00	800
28	WF2002-WS28X0X	26.00	28.80	30.00	24.00	800
30	WF2002-WS30X0X	28.00	30.80	32.00	26.00	600
32	WF2002-WS32X0X	30.00	32.80	34.00	28.00	500
34	WF2002-WS34X0X	32.00	34.80	36.00	30.00	500
36	WF2002-WS36X0X	34.00	36.80	38.00	32.00	500
38	WF2002-WS38X0X	36.00	38.80	40.00	34.00	500
40	WF2002-WS40X0X	38.00	40.80	42.00	36.00	500
42	WF2002-WS42X0X	40.00	42.80	44.00	38.00	500
44	WF2002-WS44X0X	42.00	44.80	46.00	40.00	500
46	WF2002-WS46X0X	44.00	46.80	48.00	42.00	500
48	WF2002-WS48X0X	46.00	48.80	50.00	44.00	500
50	WF2002-WS50X0X	48.00	50.80	52.00	46.00	500

No.	Dim(D)
1	3.0
2	2.5

OPERATION	SCALE	FIT
XX	±0.40	mm
XX	±0.25	mm
X.XXX	±0.15	mm
Angle	± 3'	
DIM	TOL	

OPERATION	DRAW	DATE
XX	JYHuang	2013/01/30
XX	CHECK	DATE
X.XXX	APPROVE	DATE
Angle	SHEET	
DIM	PROJ.	

PART NO.	SEB TAB
PHD2.0 WAFER 180°	
Customer NO.	

**hf** 上海回峰电子科技有限公司  
 Shanghai Hui Feng Electronic Technology Co., Ltd.

电话: 021-67150229  
 传真: 021-67150251  
 企业邮箱: huiheng\_dz@163.com  
 公司地址: www.huiheng-china.com

REV	DATE	MODIFICATION DESCRIPTION	CHANGE
A1	2013/01/30	Add The 04 Pin Configuration Draw	
A0	2012/09/05	NEW	

REV	DATE	MODIFICATION DESCRIPTION	CHANGE
1			
2			
3			
4			
5			
6			
7			
8			
9			
10			