

# HSF

**TECHNICAL SPECS:**

Current Rating: 1.0AMP  
 Contact Resistance: 10m Ω Max  
 Dielectric Strength: Min 1000Vrms  
 Mechanical Life: Min 100 cycles  
 Mating Pin: φ0.40 to φ0.56mm  
 Forces: (polished steel gauge φ0.43mm)  
 Insertion: 200g Max/Pin, Withdrawal: 60g Min/Pin  
 Operation Temperature: -40°C to +105°C

Sleeve: Brass CuZn36Pb3(C36000), Sn over Ni  
 Contact Clip(4 finger): BeCu(C17200), Au or Sn over Ni  
 Insulator Material: PPS+30%G.F(UL94V-0)  
 06P~18P Insulators without center bar  
 20P~28P Insulators with center one bar

## Ordering Information

7110-301 XX S XX 074 X 1

Row of Pitch    No. of Pin    Contact Plating    Packing  
 l=7.62mm    See tab    S0=Gold Flash/Tin    T=Tube  
 S3=10u"Gold/Tin    A=Tray  
 S4=15u"Gold/Tin  
 S5=30u"Gold/Tin  
 SN=Tin

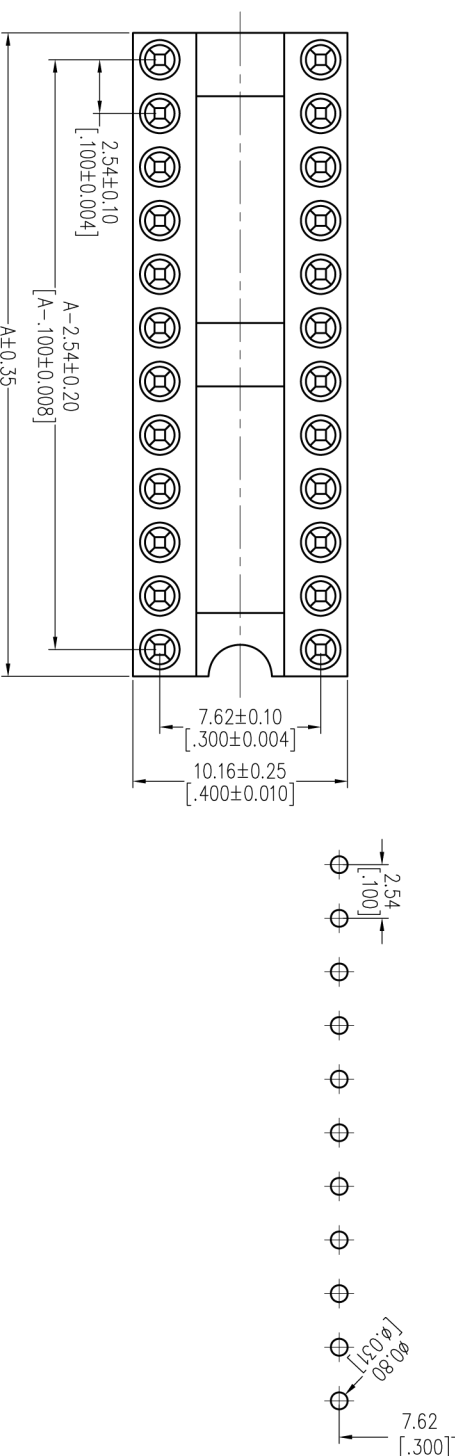

Recommended P.C.B Layout(Top Side)  
 (PCB BOARD TOLERANCE±0.05)



**Dimensional & Ordering Information**

| NO. of Poles | Part No.           | Dim   |  |
|--------------|--------------------|-------|--|
|              |                    | A     |  |
| 06           | 7110-30106SXX074X1 | 7.62  |  |
| 08           | 7110-30108SXX074X1 | 10.16 |  |
| 10           | 7110-30110SXX074X1 | 12.70 |  |
| 14           | 7110-30114SXX074X1 | 17.78 |  |
| 16           | 7110-30116SXX074X1 | 20.32 |  |
| 18           | 7110-30118SXX074X1 | 22.86 |  |
| 20           | 7110-30120SXX074X1 | 25.40 |  |
| 22           | 7110-30122SXX074X1 | 27.94 |  |
| 24           | 7110-30124SXX074X1 | 30.48 |  |
| 28           | 7110-30128SXX074X1 | 35.56 |  |

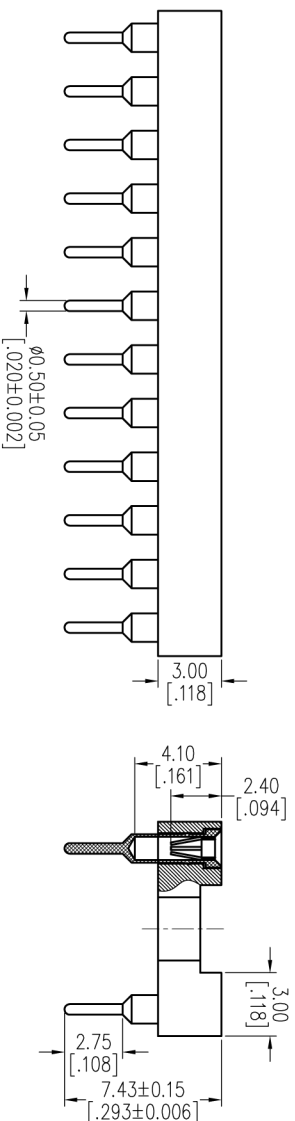

PART NO. SEE TAB

TITLE: IC SOCKET 180° H=3.0 L=7.43

2.54mm Row of Pitch 7.62

Customer NO.



**上海回峰电子科技有限公司**  
 Shanghai Hui Feng Electronic Technology Co., Ltd.

电话: 021-67150229  
 传真: 021-67150251  
 企业邮箱: hui Feng\_dzkj@163.com  
 公司网站: www.hui Feng-china.com

| REV | DATE       | MODIFICATION DESCRIPTION | CHANGE DIM | TOL   |
|-----|------------|--------------------------|------------|-------|
| A0  | 2012/11/02 | NEW                      | Angle      | ± 3°  |
|     |            |                          | XXXX       | ±0.15 |
|     |            |                          | XX         | ±0.25 |
|     |            |                          | XX         | ±0.40 |

| OPERATION | DRAW       | DATE | SCALE | FIT |
|-----------|------------|------|-------|-----|
| JYHuang   | 2012/11/02 | mm   | A4    | 1/1 |
| CHECK     | DATE       |      |       |     |
| APPROVE   | DATE       |      |       |     |

| OPERATION | DRAW       | DATE | SCALE | FIT |
|-----------|------------|------|-------|-----|
| JYHuang   | 2012/11/02 | mm   | A4    | 1/1 |
| CHECK     | DATE       |      |       |     |
| APPROVE   | DATE       |      |       |     |